



19 Pleasant Avenue

Great Houghton, Barnsley, S72 0BU

£155,000



A good-sized mid-townhouse offering three generously proportioned bedrooms, two reception rooms, and a well-proportioned rear garden with parking. This is a real family home, ideally located in the heart of Great Houghton, with a wide range of local amenities right on your doorstep.

CALL BEECROFT ESTATES TO BOOK YOUR VIEWING !



- Entrance Hallway
- Lounge
- Dining Room
- Kitchen
- Utility
- Master Bedroom
- Bedroom Two
- Bedroom Three
- Bathroom
- Exterior

Area Map



Floor Plans

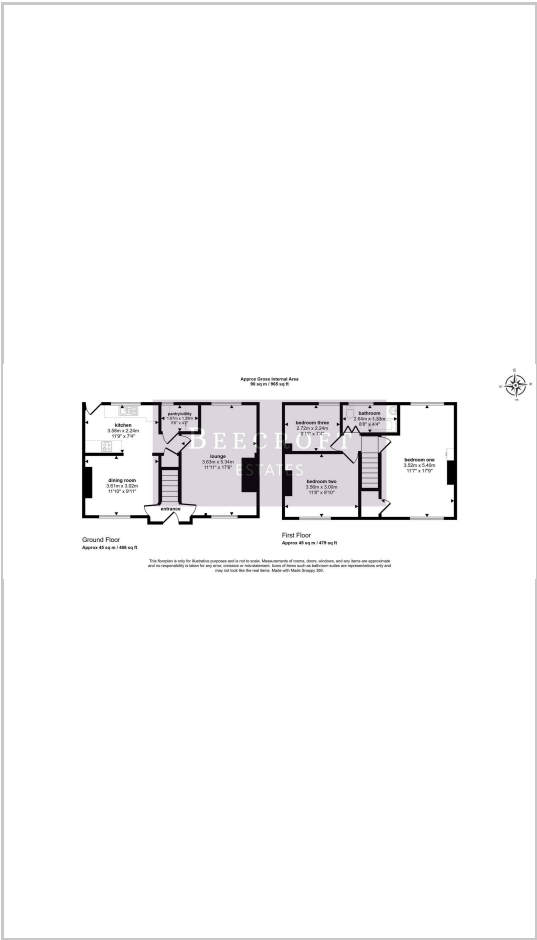

Energy Efficiency Graph

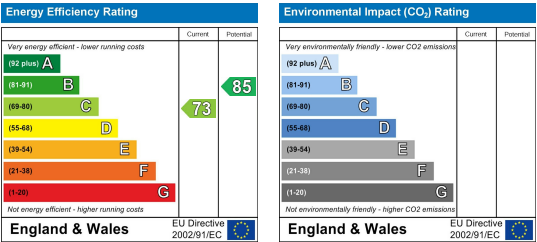

These particulars, whilst believed to be accurate are set out as a general outline only for guidance and do not constitute any part of an offer or contract. Intending purchasers should not rely on them as statements of representation of fact, but must satisfy themselves by inspection or otherwise as to their accuracy. No person in this firms employment has the authority to make or give any representation or warranty in respect of the property.